

NNNi
ULSTER
MUSEUM



MAP

ACCESS TO THE MUSEUM

The Ulster Museum is here for all. We are working to make the Museum more accessible for everyone to enjoy.

If you need more information please speak to us at reception, level 0 or Visitor Guides around the building.

Email

ulstermuseumreception@nationalmuseumsni.org

Telephone

028 9044 0000



Many of our galleries have ramped access, check descriptions in the map or ask our team to identify the best route. The Deep Time gallery is not suitable for wheelchairs or buggies.

We have push wheelchairs available and two wheelchairs with Power Assist Devices available for anyone who may require one. Please speak to reception.



Some of our galleries are fitted with stair lifts. These can only be operated by staff – please speak to a Visitor Guide to use.

Tell us what you think. Scan here to take part in our survey.

ulstermuseum.org



We provide large print labels for all of our temporary exhibitions on levels 4 and 5. Pick up a copy in the gallery or ask a member of our team.

Some of our collections are sensitive to light. To protect them, we occasionally need to keep the light levels in some of our galleries low.



Reception on level 0 has an Induction Loop. All videos in the Museum are subtitled in English.



There are enhanced Accessible Toilets with changing facilities available on the Ground Floor. Follow the signs for the Belfast Room.



The Museum can sometimes be crowded and noisy. The quietest time to visit is usually between 10.00 and 11.00, but this varies. Contact us to find out more.



ART

Encounter the very best of the national collections in our beautiful art galleries. You'll discover works from the 16th century to ultra-modern fashion and furniture, paintings, prints, sculpture and silverware. See featured exhibitions of work by local, national and international artists. Visit our website for details of exactly what will be on when you visit.

Take the lift to level 5.

NATURE

Discover the wonders of the natural world and the origins of the Earth in our natural science galleries. Gaze on beautiful crystals, amazing fossils and explore how nearly two billion years of geological history are preserved in the rocks of this island.

Take the lift to level 3.

HISTORY

Journey through history as you go from Ulster's earliest people, through turbulent times of war and conflict to periods of peaceful development and progress. Our collection contains a wealth of fascinating artefacts from 10,000 years ago to the present day. Keep a lookout for an ancient gold and a power loom from the world's largest linen producer.

Take the lift to levels 1 or 2.

WINDOW ON OUR WORLD

Window on Our World rises three storeys through the centre of the building and houses the most impressive pieces from each of our collections. It's dominated by a replica of one of Ireland's most impressive Celtic Crosses and a cannon retrieved from the sunken ships of the Spanish Armada.

Walk up the ramp from reception or see into Window on Our World from the Modern History or Nature galleries.

DISCOVERY SPACES

Experience our collections in a different way in our hands-on Discovery Spaces – Discover Art, Discover Nature and Discover History. They are the perfect places to create your own art, get up close to tiny creatures under a microscope, or make connections between the past and the present. Everyone's welcome!

Take the lift to levels 1, 3 or 5.

RECEPTION

Find out what's happening today and meet our expert guides at the information desk in reception. Gather here for regular tours and see temporary displays showcasing all the Museum has to offer.













Enter on level 0.

BELFAST ROOM

The Belfast Room hosts regular temporary exhibitions developed in partnership with the community.

Enter on level 0.

HISTORY
WINDOW ON
OUR WORLD
CAFÉ
SHOP
BELFAST ROOM

-  Information Desk
-  Toilet Facilities
-  Baby Changing
-  Cloak Room
-  First Aid
-  AED
-  Lifts
-  Stair Lift
-  Wheelchair Ramp
-  Shop
-  Café
-  Accessible, gender-neutral toilets
-  Snack Room

YOU ARE HERE ▶

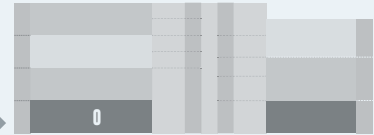

MAIN ENTRANCE



SHOP

Find a carefully curated range of merchandise at the Ulster Museum shop. Explore our collections further by delving into the wide range of books, browse the best of local design talent or pick up the perfect gift. There's something for everyone!

Enter on level 0.



CAFÉ

Hungry? You're in luck. At our Wynne & Pym café you'll find delicious savoury snacks, lunch-time meals and sweet treats along with speciality teas and fine espresso coffee. The café is named after the architects who designed this amazing building, 50 years apart.

Enter on level 0.



THE TROUBLES & BEYOND

Explore the Troubles and Northern Ireland's continuing emergence from years of conflict in the context of wider social, economic, cultural and political influences. Learn more about the history of the conflict and its impact on everyday life, people and communities through a remarkable range of objects reflecting diverse perspectives and experiences. Many objects have been contributed directly by the public as part of the 'Collecting the Troubles and Beyond' project, supported by The National Lottery Heritage Fund.

Enter through [Window on Our World](#), level 0.



Lifts



Wheelchair Ramp



Stair Lift



Discovery Space

YOU ARE
HERE

1

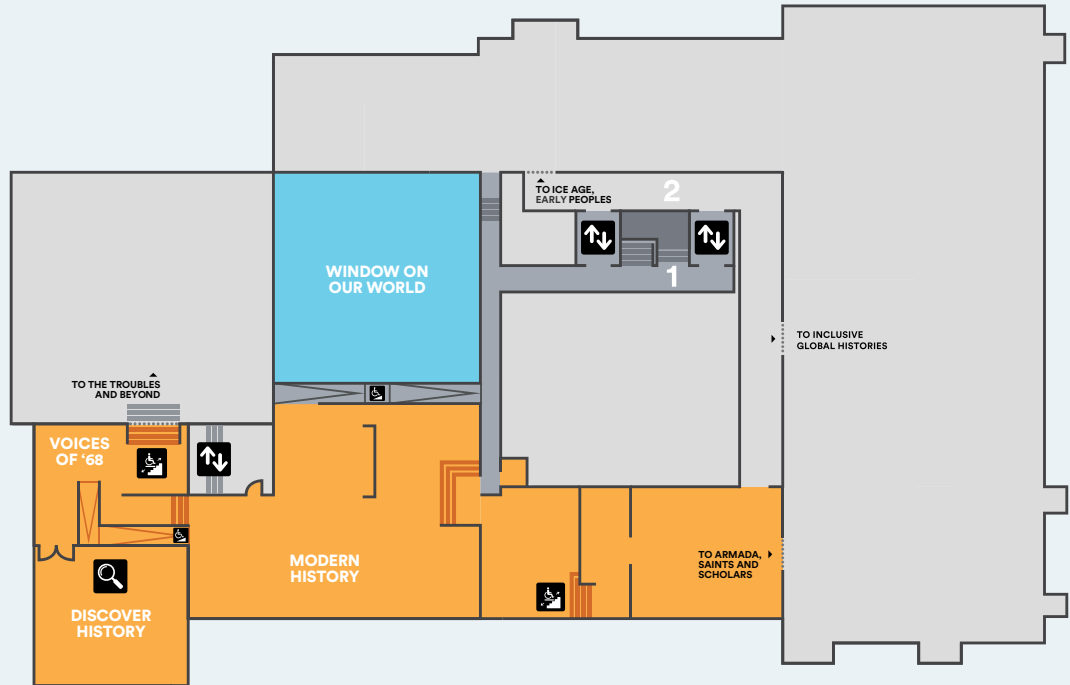

HISTORY
WINDOW ON
OUR WORLD



DISCOVER HISTORY

The Discover History space offers a fun way to explore the Ulster Museum's history, archaeology and world cultures collections. Try reconstructing a prehistoric skull, take a selfie in period costume or find the largest shoe you've ever seen! A guide is on hand to answer any questions.

[Enter through Modern History, level 1.](#)



MODERN HISTORY 1500 - 1968

Modern History is arranged around noteworthy events and themes telling the story of the historic province of Ulster from 1500 to 1968. Objects on display include the Dungiven costume, a rare 16th-century garment recovered from a bog, and the sword of Henry Joy McCracken, prominent United Irishman hanged in 1798. Many of the objects are directly connected to key events and personalities from the past 500 years – from Hugh O'Neill and Arthur Chichester, to Isabella Tod and James Connolly.

[Enter on level 2. Wheelchair and buggy users can get easier access to most of the gallery from level 1.](#)

VOICES OF 1968

VOICES OF 1968

This exhibition encourages a fresh look at a crucial period in Northern Ireland's history, told in the words of some of those directly involved at the time.

[Enter through Modern History, level 1.](#)



EARLY PEOPLES

Journey back in time through our archaeology galleries, from Ireland's first settlers (around 8000 BC) to changes brought about by Neolithic farmers (around 4000 BC). Explore the Bronze Age (around 2300 BC), when the first gold and metal objects were forged. Then see objects from around 600 BC, the beginning of the Iron Age.

[Enter on level 2.](#)

ANCIENT EGYPT

Take a glimpse at how people in Egypt lived thousands of years ago and learn about the life and death of Takabuti. Nearby, you'll find a child's wooden doll, hair combs, jewellery and cosmetic jars that were once in daily use.

[Enter through Early Peoples, level 2.](#)

ARMADA

Stories of tragedy and treasure abound in this collection of international importance dedicated to the ill-fated Spanish Armada of 1588. The ships wrecked along the Irish coast include the Girona, laden with gold and personal wealth, and La Trinidad Valencera, bristling with weapons of war.

[Enter from level 2 walkway.](#)

SAINTS & SCHOLARS

Discover how the spread of Christianity in Ireland (around AD 500) was accompanied by new writings and objects made for the church. Learn of Viking invaders and the end of medieval Gaelic Ireland (around AD 1600), marked by evidence of conflict.

[Enter through Early Peoples, level 2.](#)

INCLUSIVE GLOBAL HISTORIES

This exhibition represents the start of our journey towards decolonisation, diversity and inclusion. Through this exhibition, the Ulster Museum is re-evaluating its World Cultures collection, to better understand the complex global stories of some 4,500 items and the options for their future.

[Enter from level 2 walkway.](#)



Lifts



Wheelchair Ramp



Stair Lift



Discovery Space

YOU ARE
HERE

3



NATURE
WINDOW ON
OUR WORLD



FOSSILS & EVOLUTION

Explore spectacular fossils from a 'graveyard' of tiny ammonite shells to a toothsome, four-metre long fish. See skulls of dwarf elephants and giant deer. Discover why your skeleton isn't that different from a monkey, a mouse or a mole.

Enter from level 4 walkway.

LIVING WORLD

Learn more about life on Earth – both past and present. Explore fossil algae, the bizarre shells of ammonites and the alien forms of trilobites. See modern starfish, giant clams and an emperor penguin. Marvel at the coelacanth, a fish thought extinct until 1938, and the passenger pigeon, driven to extinction by 1914.

Enter on level 3.

ORIGINS/EARTH'S TREASURES

Touch a fragment from a planet's core, formed at the dawn of our Solar System 4.5 billion years ago. Wonder at the variety of minerals and crystals found on Earth, and the UK's largest display of minerals that glow brilliantly under ultraviolet light.

Enter on level 3.



DISCOVER NATURE

Explore the natural world from exotic shells, butterflies, fossils and minerals, to local animals and birds. Take a closer look at tiny insects under a microscope and get hands-on with some of the larger objects – you can even touch an elephant's tail!

Enter on level 3.

ELEMENTS

Our 'Elements' exhibition will take you on a voyage, from the rocks beneath your feet to the most distant and ancient reaches of the universe. Everything, from microscopic viruses to vast galaxies, is made from elements. In our unique exhibition you can find out what elements look like, where they are made, how we use them and when they are considered dangerous.

Enter on level 3.

DEEP TIME & ICE AGE

Journey through time and discover Ireland's oldest rocks, ancient oceans, the age of dinosaurs and volcanic landscapes. Venture downstairs and into the Ice Ages.

Enter on level 3, through Spotlight: Nature.

-  Lifts
-  Wheelchair Ramp
-  Toilet Facilities
-  Accessible, gender neutral toilets
-  Discovery Space

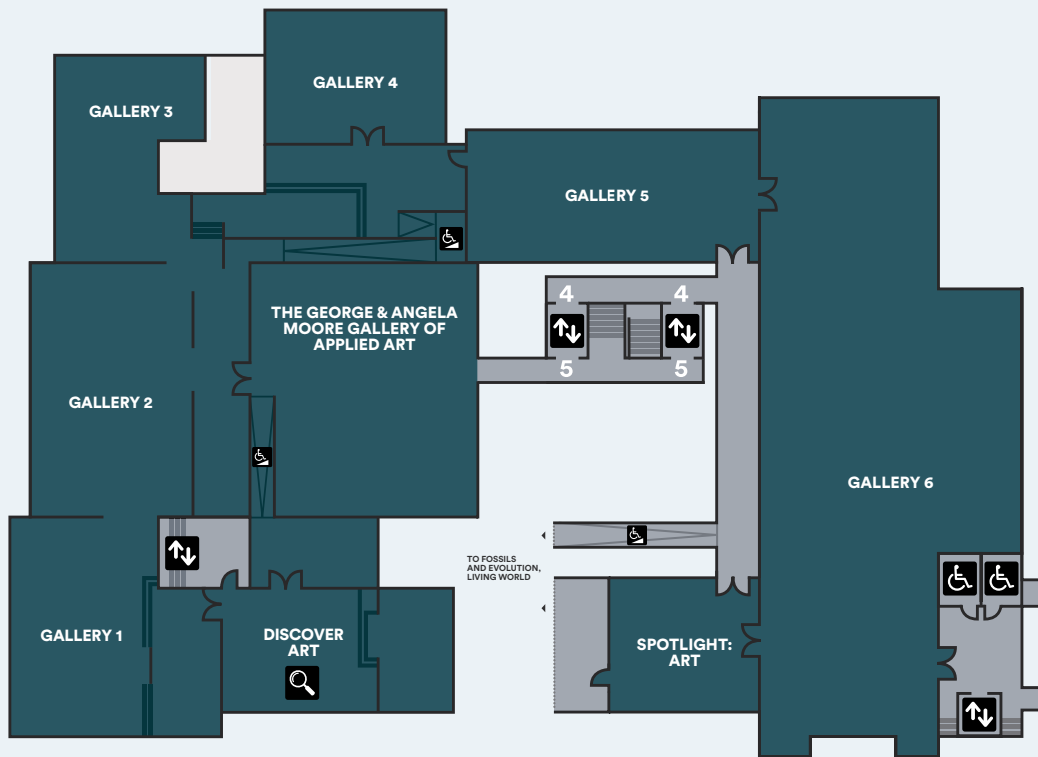
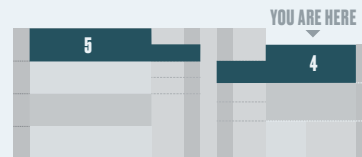



DISCOVER ART

This fun, hands-on space is a great place to exercise your artistic skills under the direction of our helpful guides. The activities draw on inspiration from current exhibitions to get you making your own creations. Perfect for kids and adults alike in a bright and airy room with views over the Botanic Gardens.

Enter on level 5.

THE GEORGE & ANGELA MOORE GALLERY OF APPLIED ART

Applied Art is the application of artistic design to everyday objects. Our collections have two areas of particular strength - the 18th century and the contemporary. Highlights include Belleek and studio ceramics, Irish glass, silver, jewellery and sculptural artworks by international artists.

Enter on level 5.



GALLERY 1 & GALLERY 2

These two spaces are for our own collections, with a focus on European and Irish Art before 1870, and special exhibitions.

Enter on level 5.

GALLERY 3

Hosting changing exhibitions of Applied Art, including our renowned fashion and textile collections.

Enter though the George & Angela Moore Gallery of Applied Art, level 5.



GALLERY 4

This intimate space is well-suited to diverse and often delicate works on paper. Exhibitions of these works run for no longer than a year, because the materials are sensitive to light.

Enter on level 4.

GALLERY 5

Irish Art after 1870 is at the centre of our collection, so we display it at the heart of our art galleries. Occasionally this space is used for temporary exhibitions.

Enter on level 4.

GALLERY 6

The largest and most flexible of our galleries. Here you can regularly view works from our 20th century and contemporary art collections. We also host a wide variety of temporary exhibitions in this impressive space.

Enter on level 4.

SPOTLIGHT: ART

Here we highlight our own collections and occasional loans with 'in-focus' displays, looking at different artists, schools and themes.

Enter from level 4 walkway.



ULSTER FOLK MUSEUM

Experience Ulster as it was over 100 years ago at this open-air Museum just outside Belfast. Discover how reconnecting with the customs and traditions of the past can help us grow and thrive in the world today.

Engage with ways of living past and present, exploring authentic exhibit buildings in the town and countryside. Meet costumed guides along the way, bringing it all to life.

See everyday skills that have been passed down over many generations being kept alive by talented makers performing daily craft demonstrations such as basket making, blacksmithing and baking.

Visit ulsterfolkmuseum.org for opening times and admission prices.

ULSTER TRANSPORT MUSEUM

Journey through time and discover the epic story of transport and social change in this part of the world.

Be inspired by the engineering giants of this small island, whose pioneering inventions across land, sea and sky have shaped our modern world.

Climb aboard steam trains, including the iconic Meadb. Explore the Titanic story through hundreds of genuine White Star objects. Visit the 'Museum of Innovation' galleries to learn the story of amazing local inventions - including the DeLorean car, brought to life through a sound and light show.

Visit ulstertransportmuseum.org for opening times and admission prices.

ULSTER AMERICAN FOLK PARK

Relive the stories of the thousands who embarked on an extraordinary journey from Ulster to America in the 18th and 19th centuries.

Engaging exhibitions and interactive displays – including the life-sized, scaled replica of the Brig Union ship many sailed on - bring history to life, transporting you from rural Ulster to the landscapes of America.

Wander through authentically recreated streets and homesteads, interact with costumed guides and witness traditional crafts and skills in action.

Visit ulsteramericanfolkpark.org for opening times and admission prices.



ULSTER AMERICAN FOLK PARK

