

NNNi
ULSTER
MUSEUM



MAP

WELCUM TAE THE ULSTER MUSEUM

Leuk intae Airt, Nattur an' History in onie ordair at suits ye uisin the lifts neirhan tae Reception. The levels o' the Museum mak' a spiral – as ye turn tae yer left ir climbin' tae the airt galleries, as ye turn tae yer richt ye ir descendin' beck tae Reception. Oor maist accessible route stairts oan level 5 in the George an' Angela Moore Gallery o' Applied Airt.

Appen 10.00 17.00, Tuesday – Sunday an' oan sim Bank holidays

Make the most of your visit

- Dinnae touch the objects ir airt.
- Nae mait ir drink in the galleries.
- Keep yer weans unner control.
- Dinnae rin – tae keep ivryboadie saife.
- Leave bags in the cloakruim, neirhan' reception.
- Respect the experience o' ither visitors.
- Ye ir welcum tae tak' picturs bit dinnae bae uisin a flash.
- Nae smokin' ir vavin' in the biggin.

Gae tae Ulstermuseum.org fer aa o' oor steerins an' laas

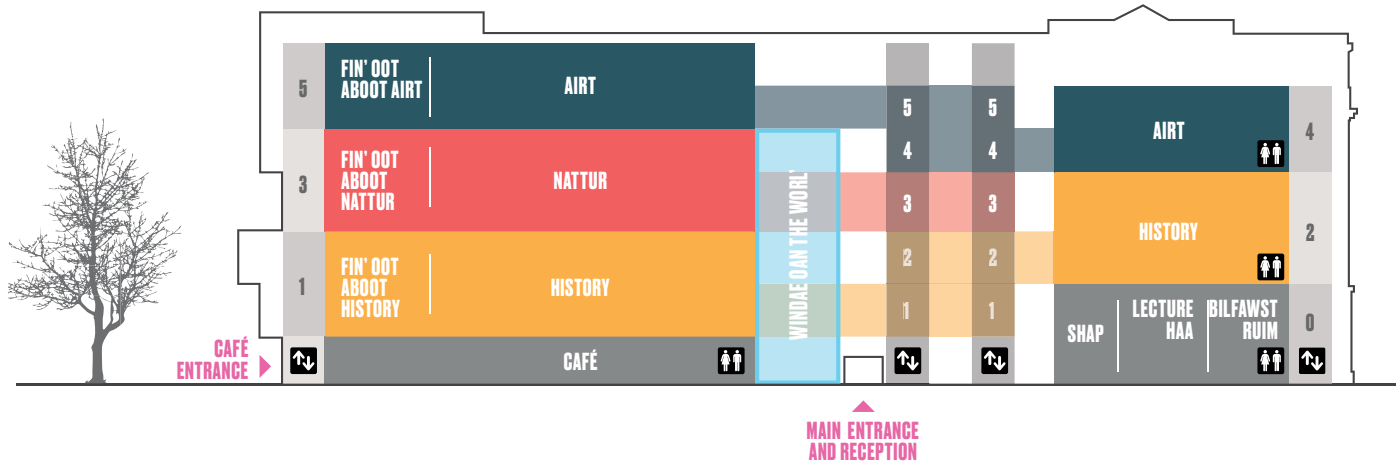

AIRT

Leuk aa the verra bes' o' the National Collections in oor bonnie airt galleries. Ye wul fin' waarks fae the 16th century tae ultra-ap tae date fashion an' furnishins, paintins an' prents, statues an' sillar. Leuk oot fer featured exhibitions o' waark bae locail, national an' inthernational artists. See oor wabsteid fer wittens aboot quhat wul bae oan quhan ye visit.

Tak' the lift tae level 5.

NATTUR

Cum oan the wonners o' the natural worl' an' the origins o' the worl' in oor natural science galleries. Leuk aa bonnie chrystals, unco fossils an' see hoo neir twa billion yeirs o' geological history ir preserved in the stanes o' this islan'.

Tak' the lift tae level 3.

HISTORY

Travel through history as ye gae fae Ulster's furst fowk through hannlins o' waar an' conflict tae tims o' peacefu' forderin an' progress. Oor collection haes monie gyely intherestin' artefacts fae 10,000 yeirs sine tae the noo. Leuk oot fer gyely auld gold an' a pouer loom fae the worls' baagest linen maker.

Tak' the lift tae levels 1 ir 2.

WINDAE OAN THE WORL'

Windae oan oor Worl' rises fer thrie flures through the hairt o' the biggin an' hooses the maist unco pieces fae oor collections. Hit baes dominated bae a replica o' yin o' Airlan's maist imposin' Celtic Crosses an' a cannon brocht ap fae yin o' the sunken schips of the Spanish Armada.

Danner tae the ramp fae Reception ir see intae Windaes oan oor Worl' fae the Modairn History ir Nattur Galleries.

DISCOVERY SPACES

Experience oor collections in a differ wie in oor hans oan Discovery Spaces – Discover Airt, Discover Nattur an' Discover History. Thon ir the perfect places tae mak' ye rain airt, get ap close tae gyely wee beasties unner a microscope ir mak' connections atween pas' an' present. Ivryboadie baes welcum.

Tak' the lift tae levels 1, 3 ir 5.

RECEPTION

Fin oot quhat baes goin oan theday an' meet wi' oor expert guides aa the wittens desk an' reception. Gaither here fer regular steered tours ir see shoart tim' displays at shewcaase aa at the museum haes tae affair.













Enter oan level 0.

BILFAWST RUIM

The Bilfawst Ruim pits oan regular shoart tim' exhibitions at ir fordered in pairtnership wi' the commonity.

Enter oan level 0.

HISTORY
WINDAE OAN
OOR WORL'
CAFÉ
SHAP
BILFAWST RUIIM

-  Wittens Desk
-  Toilets
-  Wear Chargin'
-  Cloak Ruum
-  Furst Aid
-  AED
-  Lifts
-  Stair Lift
-  Wheelchair Ramp
-  Shap
-  Café
-  Accessible, gender-neutral toilets
-  Snack Ruum

YE IR HERE ▶

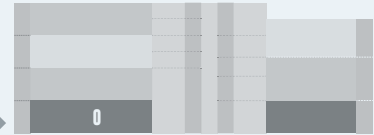



SHAP

Fin' a weill curated range o' guids fer sale aa the Ulster Museum Shap. Leuk farder intae oor collections bae delvin' injtae the baag range o' beuks, browse the bes' o' locail design talent ir pick oot the perfect giftie. Thaire's simthing fer ivryboadie.

Wie in fae level 0.



CAFÉ

Gif ye're stairved wi' hunger ye're in luck. Aa oor Wynne an' Pym Café ye'll fin' tasty savory snacks, lunchtime meals an' sweeties fer treats along wi' speciality tays an' fine espresso coffee. The café baes naimed fer the architects wha plenned this unco biggin, 50 yeirs apairt.

Wie in fae level 0.



THE TROUBLES AN' AYONT

Leuk aa the Troubles an' Norlin Airlan's oangaein emergence efter yeirs o' hannlins an' stramashes in the context o' wider social, economic, cultural an' political influences. Lairn mair about the history o' the conflict an' hit's impect oan ivryday lif', fowk an' commonities through an' unco set o' objects shewin differ perspectives an' experiences. A clatter o' objects wur wur gien directly bae fowk as pairt o' the Collectin' the Troubles an' Ayont Project hefted bae the Nationl Lottery Heirskeip Fund.

Wie in fae Windae oan oor Worl' level 5.



Lifts



Wheelchair Ramp



Stair Lift



Discovery Space

YE IR HERE ▶

1

HISTORY WINDAE OAN OOR WORL'

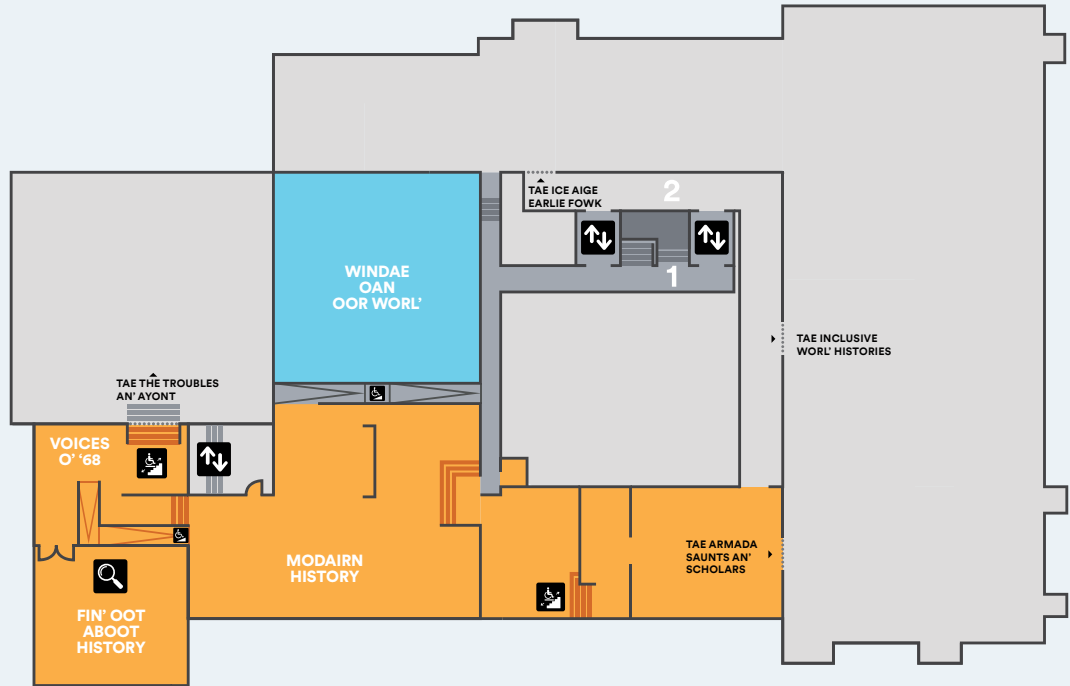



FIN' OOT ABOUT HISTORY

The Fin' Oot About History space gies a wie tae leuk aa the Ulster Museum's history, archaeology an' worl' cultures collections. Ettle aa re-maakin a pre-historic skull, tak' a selfie wearin' period claes ir fin' the baigest shoe at iver ye saen! A guide baes tae han' tae answ'er yer speirins.

Wie in fae Modairn History, level 1.



MODAIRN HISTORY 1500 TAE 19&68

Modairn History baes arranged around kenspeckle events an' daeins tellin' the story o' the historic province o' Ulster-fae 1500 tae the 19&68. Among the objects oa display ir the Dungiven Costume, a rare 16th century clout foun' in a boag an' a sword at belanged tae Henry Joy McCracken the kenspeckle United Airishman hung in 17&98. Clatters o' sich objects ir connected wi' key daeins an' wi' fowk fae the the las' 500 yeirs – fae Hugh O'Neill an Arthur Chichester tae Isabella Todd an' James Connolly.

Wie in oan level 2. Access fer wheelchairs an' buggies can get easier access tae maist o' the gallery fae level1.

VOICES OF 68

VOICES O' 19&68

This exhibition ettles aa gettin' fowk tae tak' a fresh leuk aa a gyely important tim' in Norlin Airlan's history toul in the wurd's o' sim' o' thaim directly involved aa tha' tim'.

Wie in fae Modairn History, level 1.

HISTORY
NATTUR
WINDAE OAN
OOR WORL'

-  Lifts
-  Stair Lift

-  Accessible, gender neutral toilets
-  Toilets

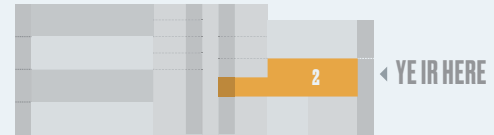



EARLY FOWK

Heid beck in tim' through oor archeology galleries, fae the furst fowk tae cum tae bide in Airlan (about 8000BC) tae altherations brocht about bae the daeins o' neolithic fairmers (about 4000BC). Leuk intae the Bronze Aige (about 2300BC), quhan the furst gold an' metal objects wur forged. Efter thon leuk aa objects fae about 600BC, the stairt o' the Iron Aige.

Wie in oan level 2.

ANCIENT EGYPT

Tak' a keek aa hoo fowk lee'd thoosans o' yeirs sine in Egypt an' lairn about the lif' o' Takabuti. Neirhan ye'll cum oan a wean's doll maide fae wud, hair combs, jewelry an' cosmetic jars at yinst wur used ivry day.

Wie in fae Earlie Fowk, level 2.



ARMADA

Thaire ir clatters o' yairns about sair hannlins an' treasure in this collection o' worl importance an' dedicated tae the ill-fairin' Spanish Armada o' 1588. Among the schips loast along the coast o' Airlan wur the Girona, at wus fu' o' gold an' personal wealth an' La Trinidad Valencera at wus bristlin' wi' baag guns.

Wie in fae level 2 padwie.

SAUNTS AN' SCHOLARS

Fin oot hoo the spread o' Christianity in Airlan (about AD 500) brocht wi' hit new screevins an' objects maide fer the church. Lairn about Viking invaders an' the enn o' medieval Gaelic Airlan (about 1600AD), marked bae evidence o' fechtin.

Wie in fae Earlie Fowk, level 2

INCLUSIVE WORL' HISTORIES

This exhibition stans fer the stairt o'oor trevels tae decolonization, diversity an' inclusion. Wi' this exhibition the Ulster Museum baes re-evaluatin' hit's Worl' Cultural collection, tae cum tae a better unnerstannin' o' the complex global yairns o' sim 4,500 items an' the options fer thaim gaein forrit.

Wie in fae level 2 padwie.



Lifts



Wheelchair Ramp



Stair Lift



Discovery Space

YE IR HERE ▶

3

NATTUR WINDAE OAN OOR WORL'





FOSSILS AN' EVOLUTION

Leuk aa remairkable fossils fae a 'graveyard' o' wee tootie ammonite shells tae a fower metre fasch wi' sarious baag teeth. See skulls fae dwarf elephants an' giant deer. Fin oot fer wie yer skeleton isnae tha' differ fae a monkey, a moose ir a mole.

Wie in fae level 4 padwie.

LEE'IN WORL'

Lairn mair about lif' oan earth – baith in tims pas' an' theday. Leuk aa fossil algae, the weird shells o' ammonites an' the alien foarms o' the trilobites. See modairn starfasch, giant clams an' an Emperor Penguin. Marvel aa the Coelacanth, a fasch thoct tae bae lang extinct 'til 19&38 an' the Passenger Pigeon wiped oot bae 19&14.

Wie in oan level 3

ORIGINS/EARTH'S TREASURES

Pit yer han' oan a wee pairt o' a planet's core, maide aa the verra stairt o' oor solar system 4 – 5 billion yeirs sine. Wonner aa the nummer o' differ classes o' minerals an' crystals foun' oan earth, an' the UK's baagest display o' minerals at shine brichtly unner ultra-violet licht.

Wie in oan level 3.



ELEMENTS

Oor 'Elements' exhibition wul tak' ye oan a voyage fae the stanes aneath yer feet tae the fardest an' maist ancient reaches o' the universe. Aa things fae microscopic viruses tae vast galexies ir maide ootae elements. In oor unco exhibition ye'll fin' oot quhat elements leuk laike, quhar they ir maide, hoo we uise thaim an' quhan they ir thoct tae bae dangerous.

Enter on level 3.

FIN' OOT ABOUT NATTUR

Speir intae the natural worl' fae exotic shells, butterflyes, fossils an' minerals, tae locail animals an' burds. Leuk hairder aa tootie wee insects unner a microscope an' get hans oan wi' sim o' the baager objects. Ye'll even bae fit tae touch an Elephant's tail.

Wie in oan level 3.

DEEP TIM' AN' ICE AIGE

Trevel through tim' an' cum oan Airlan's auldest stanes, ancient oceans, the aige o' the dinosaurs an' volcanic lan'scapes. Heid doonstairs intae the Ice Aige.

Wie in oan level 3, through Spotlight: Nattur.

YE IR HERE

-  Lifts
-  Wheelchair Ramp
-  Toilet Facilities
-  Accessible, gender neutral toilets
-  Discovery Space

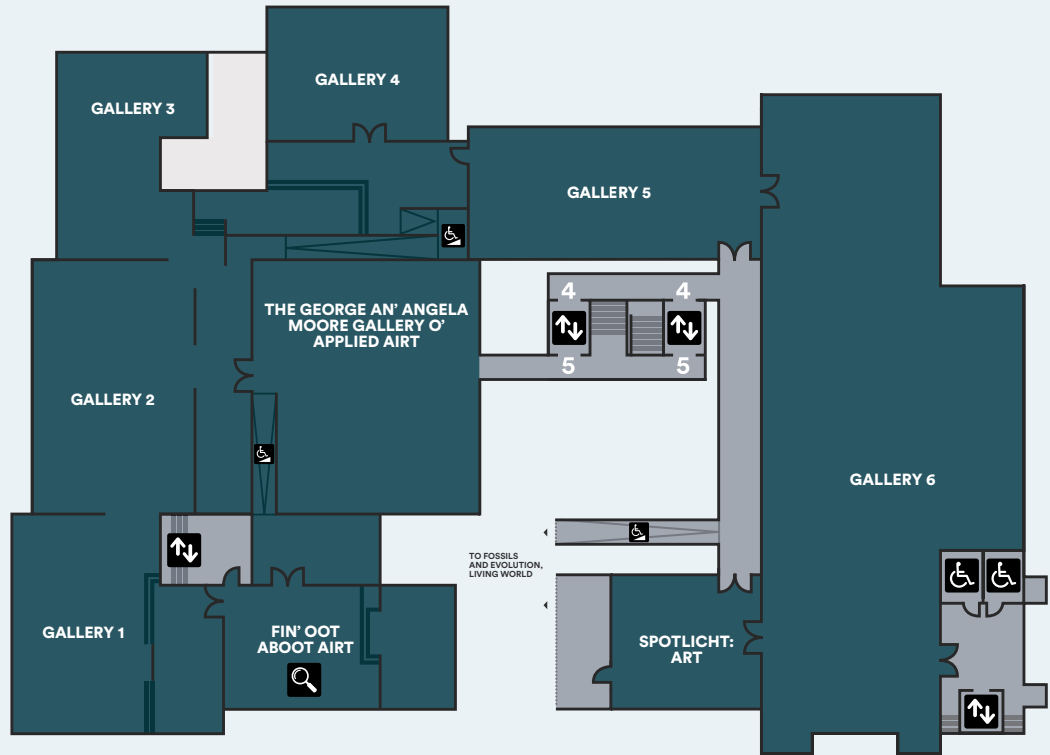
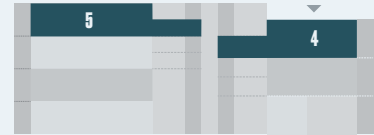

AIRT



FIN' OOT ABOUT AIRT

This fun hans oan space baes a guid spot tae uise yer artistic skeels unner the steerin o' oor heftfu' guides. Thae daeins tak' inspiration fae theday's exhibitions tae get ye maakin yer ain creations. Thon baes perfect fer baith weans an' adults in a bricht, airy ruim leukin owre the Botanic Gairdens.

THE GEORGE AN' ANGELA MOORE GALLERY O' APPLIED ART

Applied Airt baes the uise o' artistic design in the maakin o' ivryday objects. Oor collections hae twa pairticular airts o' strenght – the 18th century an' the ap tae date. Amang heighlights ir Belleek an' studio ceramics, Airish Gless, Siller, Jewelry an' sculpture bae inthernational airtists.

Wie in oan level 5.



GALLERY 1 AN' GALLERY 2

Baith o' thae spaces ir fer oor ain collections, wi' an airtin oan European and Airish airt afore 18&70 an' special exhibitions.

Wie in oan level 5.

GALLERY 3

Hostin' altherin exhibitions o' Applied Airt, taakin in oor kenspeckle fashion an' textile collections.

Wie in bae the George an' Angela Moore Gallery o' Applied Airt, level 5.



GALLERY 4

This intimate space baes weill suited tae diverse an' affen delicate waarks oan paiper. Exhibitions o' thae waarks rin fer nae mair nor yin yeir oan accout o' thaim bein' sensitive tae licht.

Wie in oan level 4.

GALLERY 5

Airish airt efter 18&70 baes aa the centre o' oor collection, sae we shew hit aa the hairt o' oor galleries. Simtims this space baes used fer temporary exhibitions.

Wie in oan level 4.

GALLERY 6

The baagest an' maist flexible o' oor galleries. Here ye're fit tae affen see waarks fae oor 20th century an' contemporary airt collections. Forebye thon we host differ clesses o' temporary exhibitions in thon impressive space.

Wie in oan level 4.

SPOTLIGHT: ART

Here we heighlight oor ain collections an' occasional lends wi' "in focus" displays at leuk aa differ artists, schuils an' themes.

Wie in fae level 4 padwie.



ULSTER FOLK MUSEUM

Experience Ulster laike hit wus mair nor 100 yeirs sine aa this appen air museum jist ootby Bilfawst. Fin oot hoo reconnectin' wi' the customs an' skeels o' the pas' can gie iz a heft grawin an' thrivin' in theday's worl'.

Engage wi' wies o' leein fae pas' an' present leukin aa true bill exhibit biggins in the toon an' kintraside, meet wi' costumed guides along the wie bringin' hit aa tae lif'. See the day's skeels at hae baen passed doon acroass the generations an' kept gaein bae skeeled maakers daein craft demonstrations ivry day laike basket maakin, blecksmithin, an' bakin.

Visit ulsterfolkmuseum.org fer appenin tims an' the price o' gettin' in.

ULSTER TRANSPORT MUSEUM

Trevel through tim' an' fin oot aboot the epic yairn o' transport an' social change in oor pairt o' the worl'.

Bae inspired bae the engineerin' giants fae this wee islan' wha maide pioneerin' inventions acroass lan', sea an' in the lift abeen at shaped oor modairn worl'.

Climb oanboord steam trains, amang thaim the iconic Meadb. Leuk intae the story o' the Titanic through hunners o' true bill White Star objects. Gae tae the Museum o' Innovation galleries tae lairn aboot unco locail inventions laike the DeLorean car brocht tae lif' through a soun' an' licht shew.

Visit ulstertransportmuseum.org fer appenin tims an' price o' admission.

ULSTER AMERICAN FOLK PARK

Relive the stories o' the thoosans wha set oot oan an unco journey fae Ulster tae Amerikey in the 18th an' 19th centuries.

Engagin' exhibitions an' intherective displays – taakin in the lif'-size, scaled coapie o' the Brig Union schip at monie fowk sailed oan – Bring history tae lif' taakin ye fae rural Ulster tae the lan'scapes o' Amerikey.

Danner alang true bill recreated streets an' hamesteids, intherect wi' costumed guides an' see traditional crafts an' skeels in ection.

Visit ulsteramericanfolkpark.org fer wittens aboot appenin tims an' prices fer getting in.



ULSTER AMERICAN FOLK PARK



AG GETTIN' INTAE THE MUSEUM

The Ulster Museum baes here fer ivryboadie. We ir waarkin tae mak' hit easier fer ivryboadie tae get intae the Museum an' enjoy hit.

Gif ye're needfu' o' mair wittens get oantae iz aa Reception, level 0 ir leuk aa the steerins fer visitors aroun' the biggin.

Epoast
ulstermuseumreception@nationalmuseumsni.org
Tellyphone
028 9044 0000



Monie o' oor galleries hae access ramps, leuk oot fer descriptions in the map ir ax oor team tae point oot the bes' route. The Deep Tim' Gallery isnae apt fer wheelchairs ir buggies.

We hae push wheelchairs tae han' an' twa wi' pouer assist devices. Onieboadie needfu' o' yin o' thaim shud ax aa reception.



Sim o' oor galleries hae stairlifts at can onie bae operated bae staff – Ax a visitor goude aboot usin thaim.

Gie iz yer notions. Scan here tae tak' pairt in oor speirin.

ulstermuseum.org



We use Baag Prent labels fer aa o' oor temporary exhibitions oan levels 4 an' 5. Pick up a coapie in the gallery ir ax a member o' staff.

Sim o' oor collections ir sensitive tae licht. Tae bield thaim sim tims we hae turn doon licht levels in sim o' oor galleries.



Reception oan level 0 haes an Induction loop. Ivry video in the Museum baes sub-titlet in Inglis.



Thaire ir Betther Accessible Toilets wi' changin' facilities oan the grun flure. Follae the signs tae the Bilfawst Ruim.



Baetims the Museum can bae crowded an' gyely noisy. Maistly the quiet pairt o' the day wul bae atween ten an' eliven in the day, bit thon althers. Get oantae iz tae fin' oot mair.

